

# NAPA NAIL TABLE ASSEMBLY INSTRUCTION

## Step 1 : Install the wheels .

- \_ Flip the 2 table bodies over (see drawing 1) .
  - \_ Put the wheels into the casters
  - \_ Put a wooden piece into each gap in the middle of the wheel .
- Hammer the wooden piece until a “pop” sound is heard .

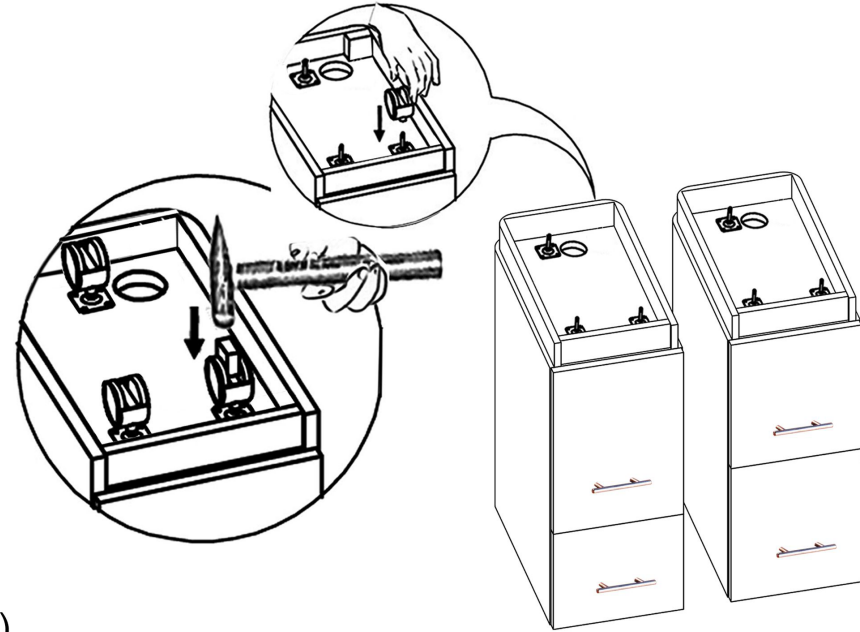

## Step 2 : Pull the left drawer of the table top out .

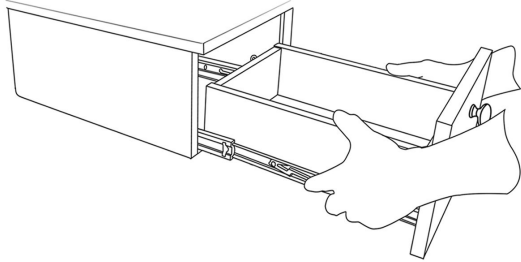

## Step 3 : Intall the table top.

- \_ Place the 2 table bodies as shown in drawing 2 (wheels to floor) .
- \_ Place the table top so that it fits into the mounting hole .
- \_ Bolt from table top to table bodies , each side 4 bolt . ( Type : 1”3/16 ) .

*Drawing 1.*

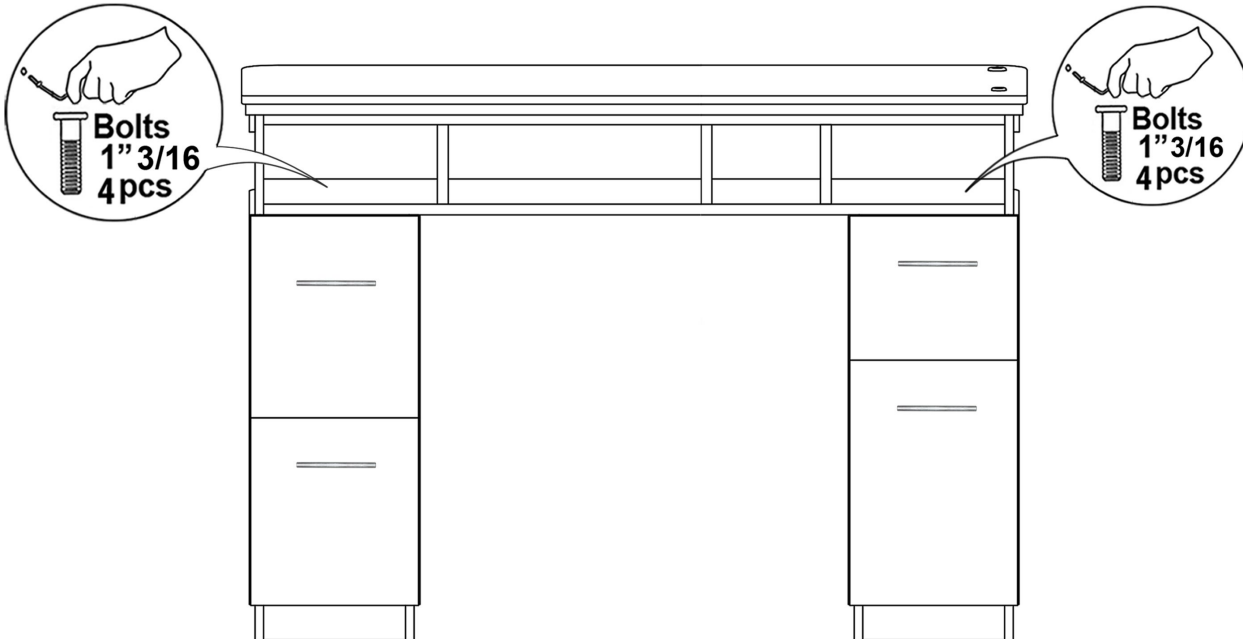

*Drawing 2.*

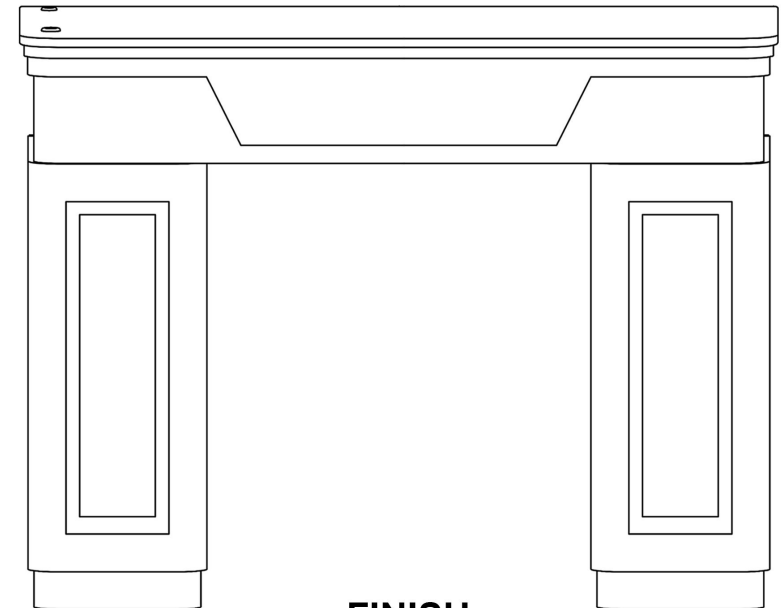

**FINISH**